

Connecting your own device to Turrumurra High School WiFi

Windows 10

1. Click on the wireless connection icon at the bottom right of your screen



2. Select “detnsw”

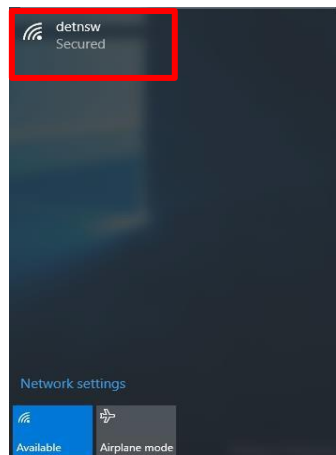

3. Click “Connect”

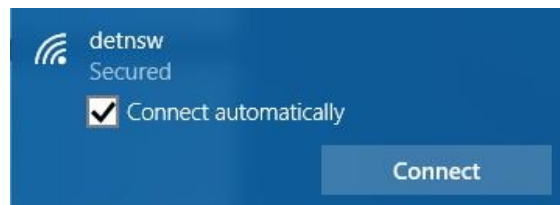

4. Enter your DET Internet username and password in the pop-up box. You need to add @detnsw to your username and click **OK**. For example, [john.citizen@detnsw](#)

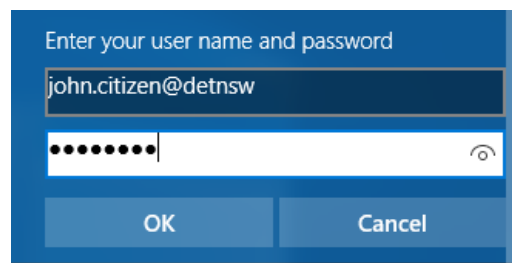

5. Click “Connect”.

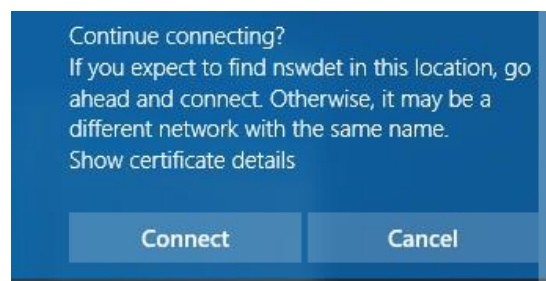

6. Go to Network Proxy Settings.

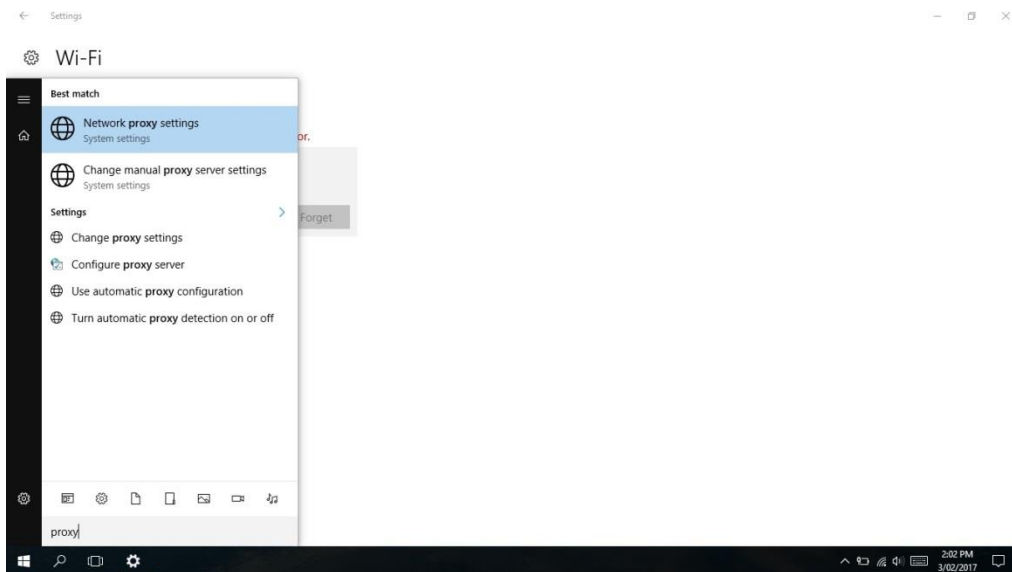

7. Select Use Setup Script

On the Script Address Type: <http://pac.det.nsw.edu.au/fib/proxy.pac>

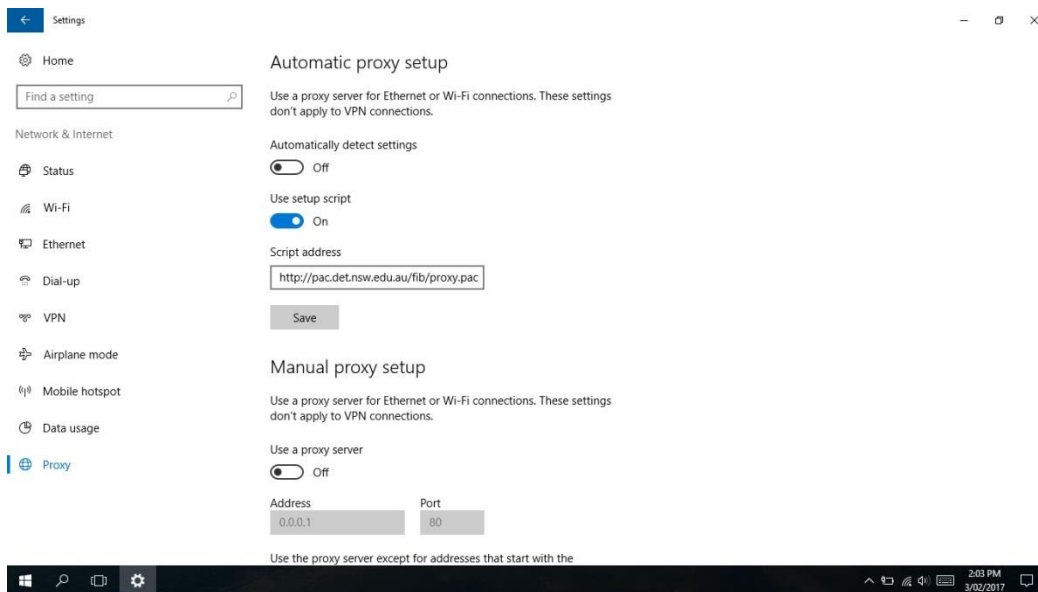

8. Open any browser (IE, Edge, Chrome, etc.) and go to http://detnsw.net

User Name: Your school username with @detnsw at the end (e.g. joe.smith@detnsw)

Password: your school password.